



Instructions for Smart Wifi control kit

Wiring electrics



LED Light (Awning)

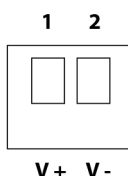

1. V+ = Wire with white line
2. V- = Wire with transparent line

Motor (Awning)

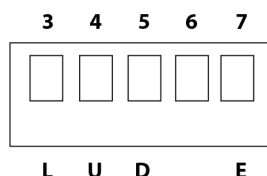

3. L = Blue Wire
4. U = Brown Wire
5. D = Black Wire
6. = No Wire
7. E = Yellow and Green Wire

Mains (Power)

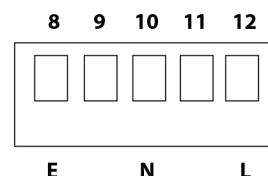

8. E = Yellow and Green Wire
9. = No Wire
10. N = Blue Wire
11. = No Wire
12. L = Brown Wire

Setting up: Remote control

- Press "P2" on top of Wifi box (LED light flashes)
- Press "Stop" on top of Wifi box (LED light will flash brighter)
- Press "UP" on remote control zapper
- Device will bleep (Syncing with remote control)
- Setup is now complete

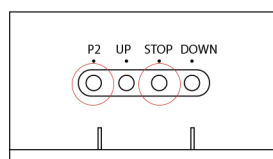

Setting up: Smart device

- Download QR code scanner/reader on APP store
- Open QR reader and scan the correct QR code for Android or Apple device
- Open link in browser, download APP "Awning"

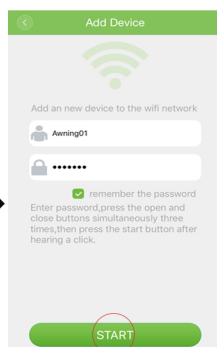
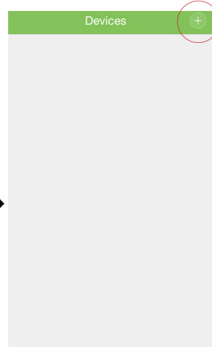
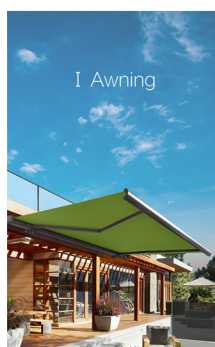
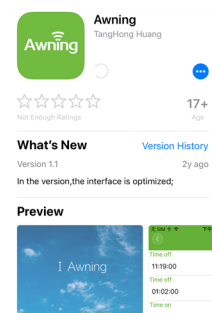
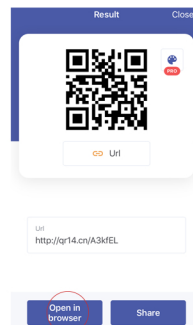
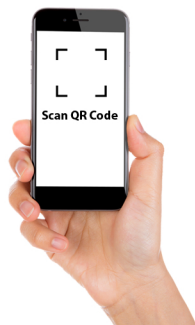
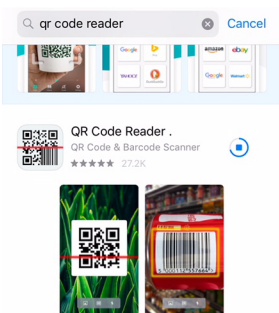

1. Enter Username and Password (Same as Wifi network)
2. Press "START" button **first** on the APP
3. Press "UP" and "DOWN" buttons at the same time (x 3)
On the third time, hold for 10 seconds.
4. Smart box will bleep and start connecting
5. Connection complete, click and use your awning

- If "Connection failed" appears, unplug mains power
- Delete and remove awning APP off all devices
- Redownload and open APP, repeat steps 1,2,3

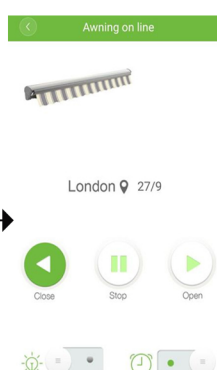
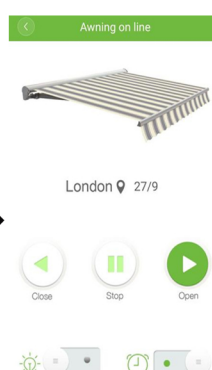
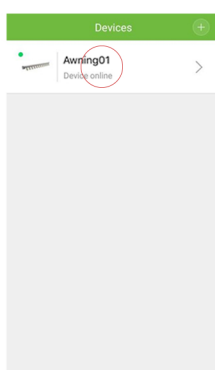
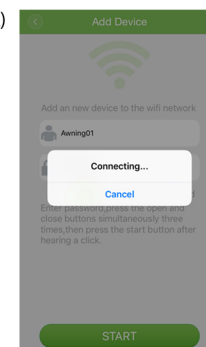
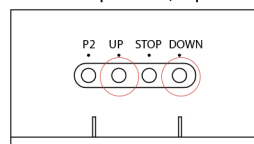

Note: If you've connected your device to the receiver box and then switch the mains power off. The awning will show "Device offline" on the APP.

Switch the mains power back on, open the APP, you'll need to wait 60 - 120 seconds for the receiver box to connect with the APP. The awning will show "Device online".

If it's still showing "Device offline"
Force Close and restart the APP (Don't delete/remove APP)

