

EM6760



**WARNING! THIS INSTRUCTION MANUAL SHALL BE READ
BEFORE THE USE AND THE INSTALLATION OF THE PRODUCT**

Important safety instructions. It is important for the safety of persons to follow these instructions. Save these instructions.

Before opening the awning, make sure all the fixing bolts and security devices are properly installed and tightened. Always close the awning during rainy days, windy days or the awning is not in use.

Failed to observe the instruction may lead to material and constructional damage of the awning.

The folding arms of the awning are under tension and can cause damage and injury when they are open up suddenly. Never try to disassemble the awning or repair the awning by yourself. Consult a competent technician for help.

To avoid the risk of tipping, the object must be firmly fixed to the wall. Improper installation can cause furniture/objects to fall and cause serious personal injury.

If you have any questions about the installation, please consult our customer service staff. Use electric drills, wrenches and ladders that are suitable for your wall material type. These are not included. For advice on tools that fit your wall, please consult our customer service staff.

1.ASSEMBLY

The installation can be made by non-professionals assuming the instruction is followed correctly. Should you have any trouble during assembly, please consult a qualified person for help.

The operation in frosty conditions may damage the awning.

Never install it in high and windy places, as the sunshade may drop and hurt people.

Don't hang anything on the frame or on the folding arms as the awning may fall down and cause damage or personal injury.

Be careful with your finger during installation.

When you are ready to unpack and assemble the awning, make sure that you have the appropriate tools, sufficient operators (2 persons are suggested) and space, and a clean and dry area to perform the installation."

Please use all the screws and nuts correctly during installation as it is very dangerous if you leave it loose.

Carefully unpack and release the bindings. Need two persons to handle the product.

Remove and store the hardware in a safe place to avoid losing.

Beware of the sudden unfolding of any parts, especially the folding arms.

Read the assembly instructions carefully before installation.

Check for missing components and damaged parts. Do not install the product if any parts are missing or damaged. Ask the store for free replacement. Never modify the construction or the design of the awning. Fail to follow the instruction can lead to personal injury or death.

The awning can be installed by non-profession provided the instructions are followed.

Make sure the wall is strong enough and is suitable for the installation of the awning. We will not be responsible for any damage to the property and the awning due to the weak support of installation wall.

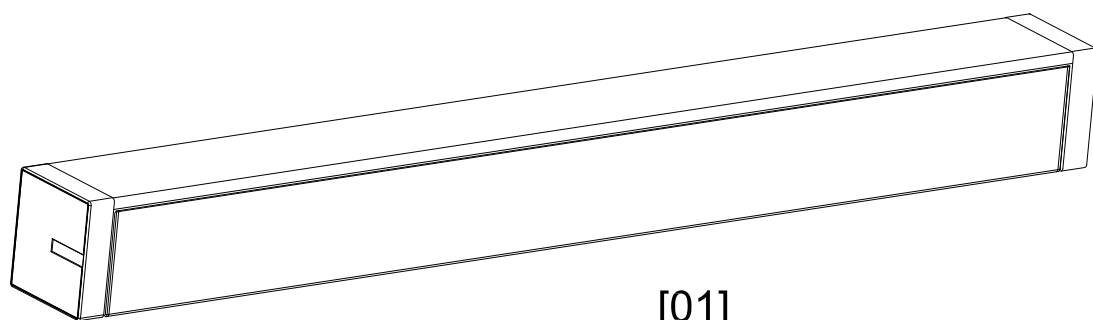
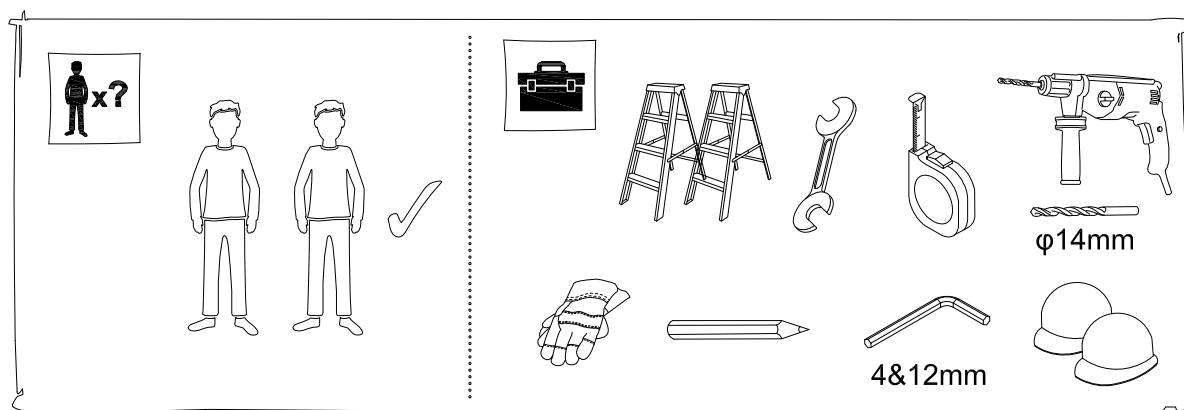

[01]
x1



[02]
x1



[03]
x1

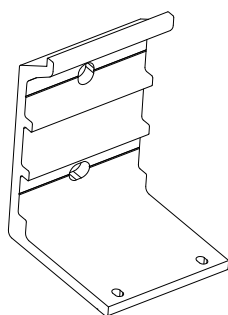

[04]
x2 or x3



[05]
x4 or x6



[06]
x4 or x6



[07]
x1



[08]
x1

01

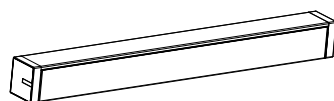

[01]x1

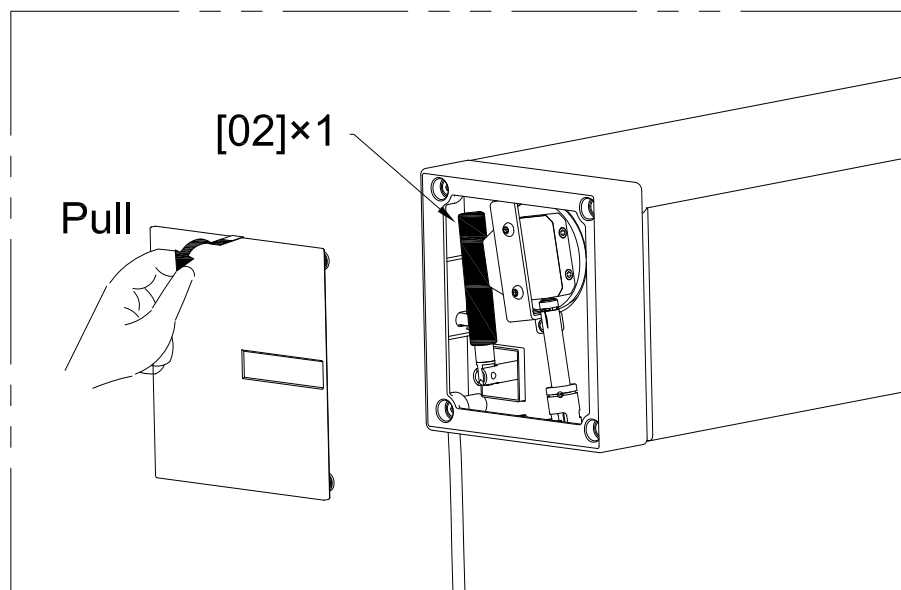

02



[02]x1



[08]x1

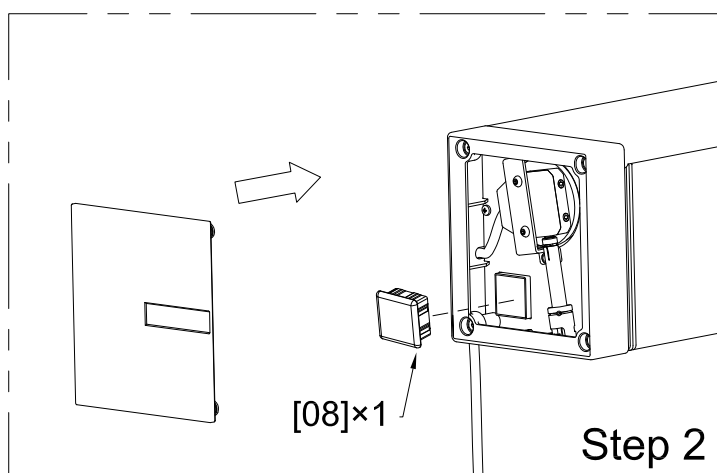
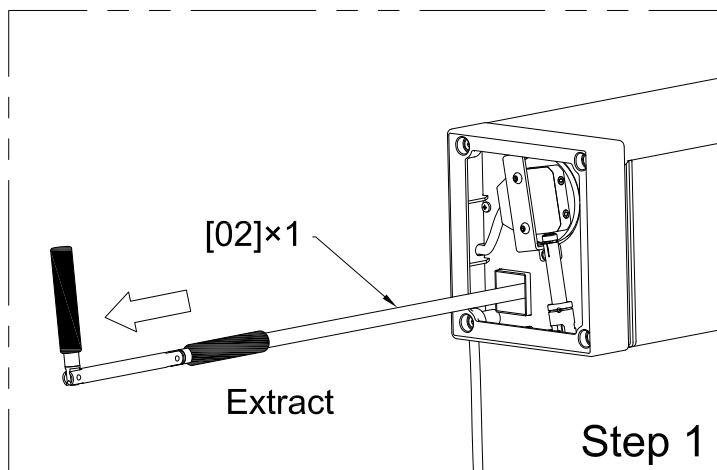

03

Product specifications

Total length < 3.6M

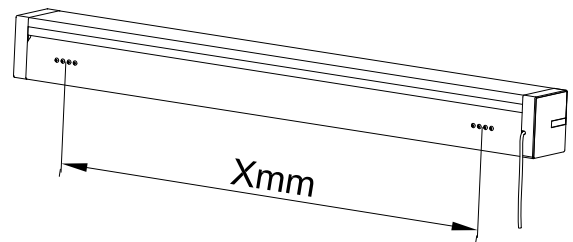

Total length > 3.6M

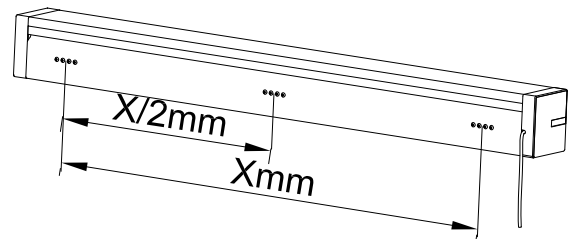

Total length	
<3.6M	>3.6M

04

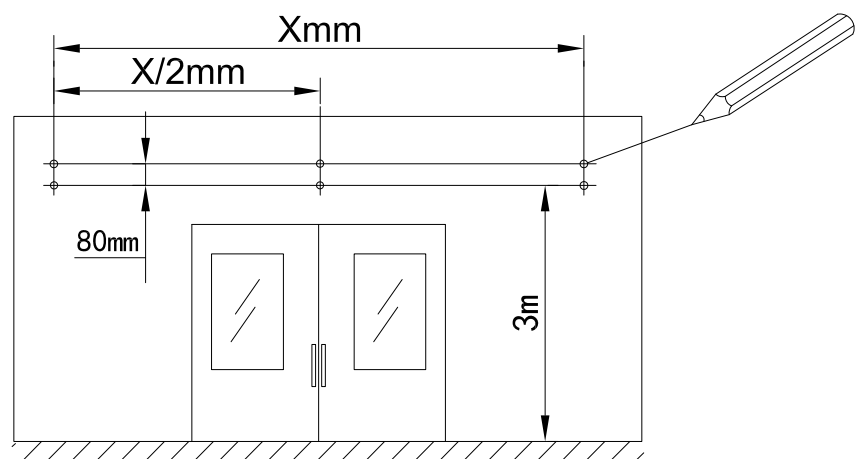
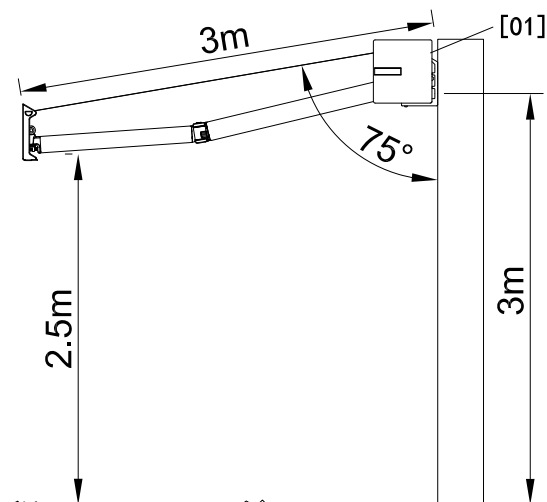

Product specifications<number of wall seats>

<3.6M

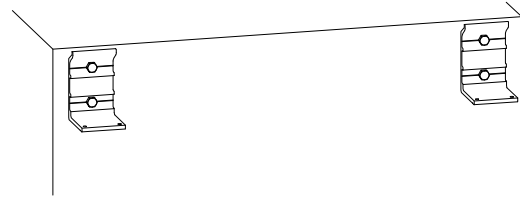

>3.6M

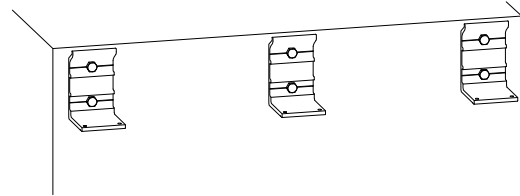

Attention: The upper and lower ends of the wall base should be kept horizontal, and it is recommended to use a leveling ruler for leveling

05

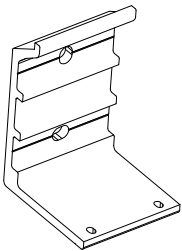

[04]x2orx3

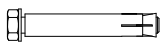

[05]x4orx6

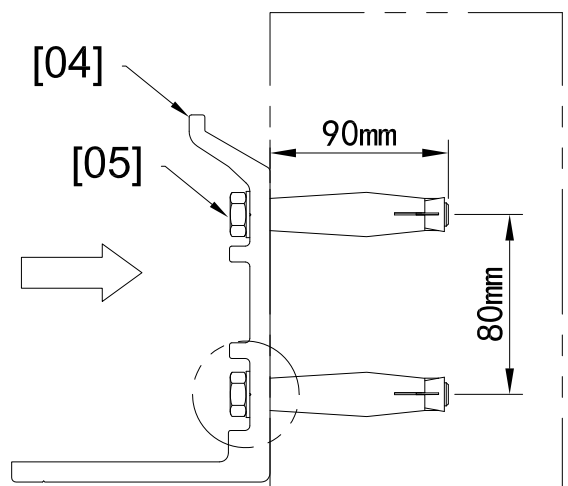
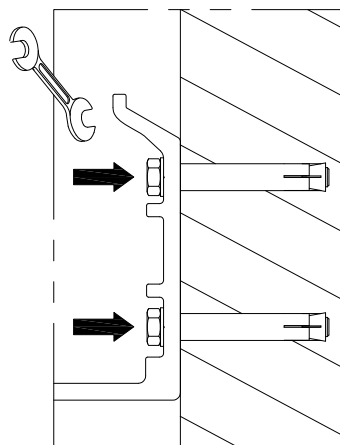
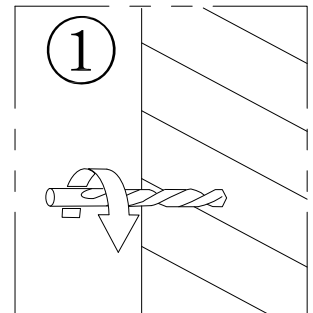
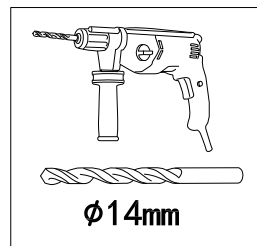

x2 or x3

06

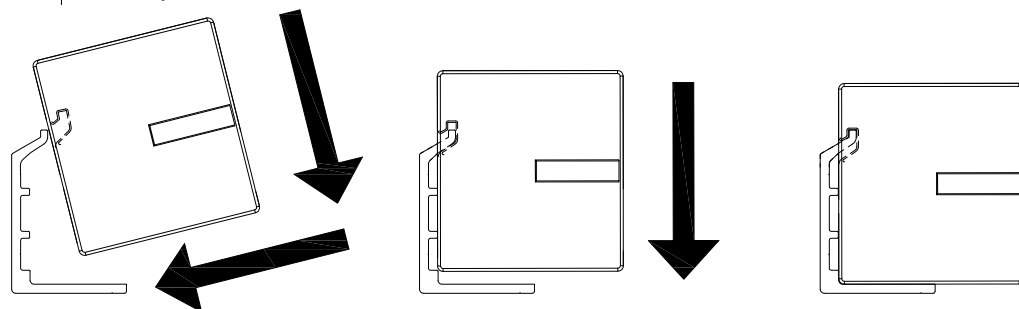
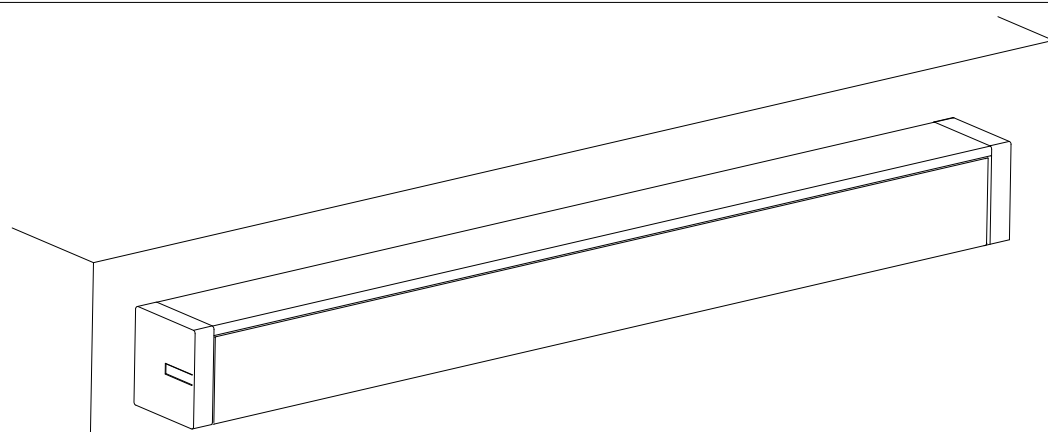

Attention: The product installation must be in place

 [06]x4orx6

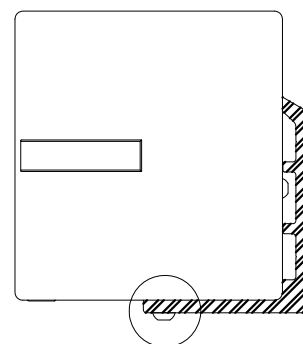
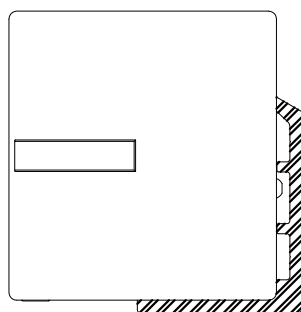

x2 or x3

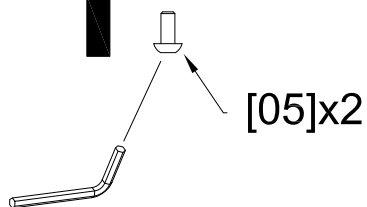

Tighten
4# Allen key



Warning:

Before officially using this product, please confirm all installation steps in step six

07



[02]x1

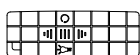

[03]x1

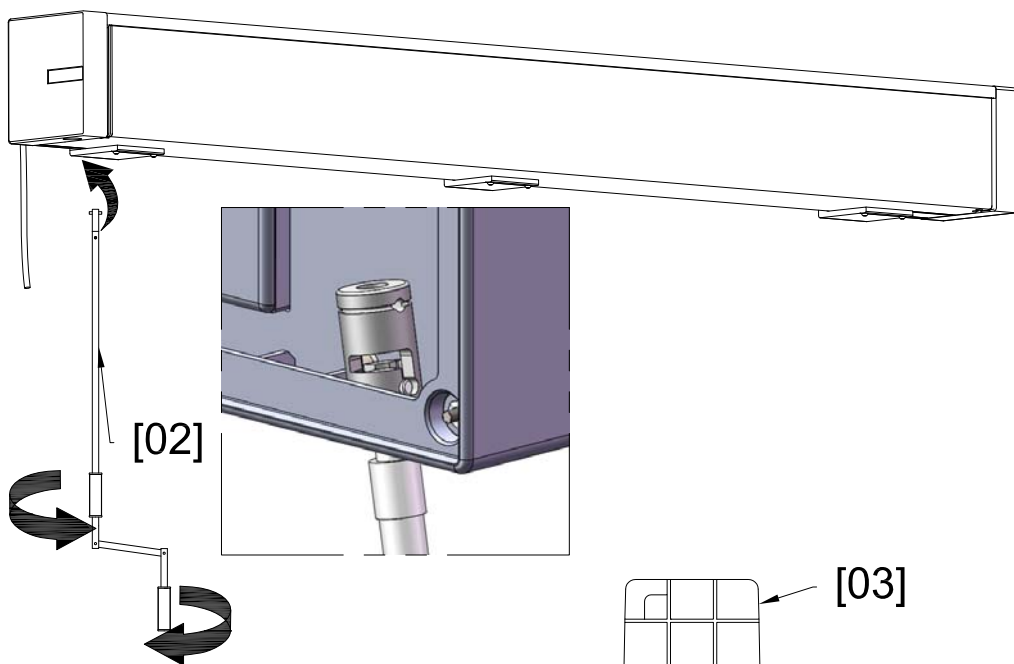

[02]

or

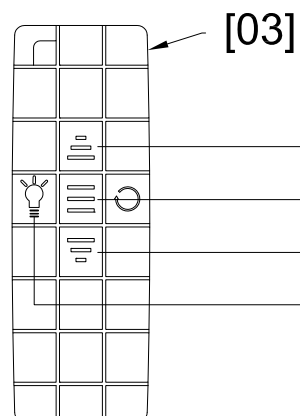

OPEN
STOP
CLOSE
LED

08



12mm

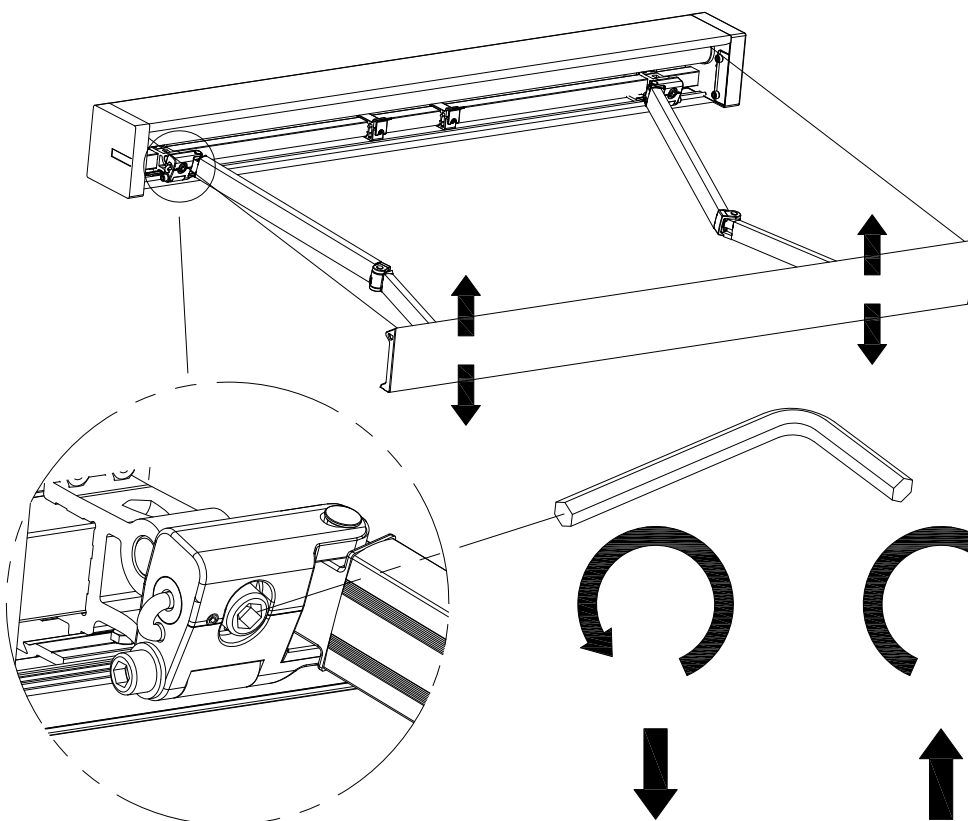

09



[07]x1

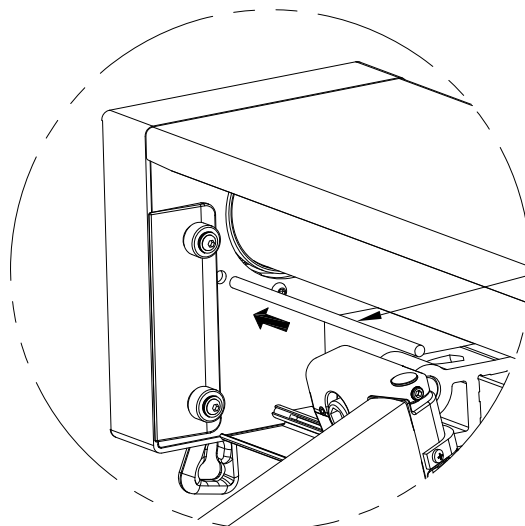

Find a short stick and push the end cover upwards from the position shown in the diagram

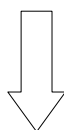

Adjust with dedicated tools

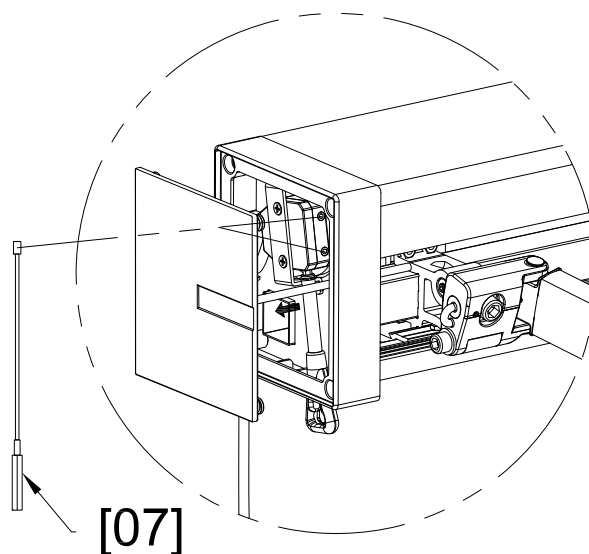

[07]

P1		adjustment tool for motor controls	
P2		the direction of "close" the awning	
P3		" + "Increase the "close" distance	
		" - "Reduce the "close" distance	
P4		the direction of "open" the awning	
P5		" + "Increase the "open" distance	
		" - "Reduce the "open" distance	

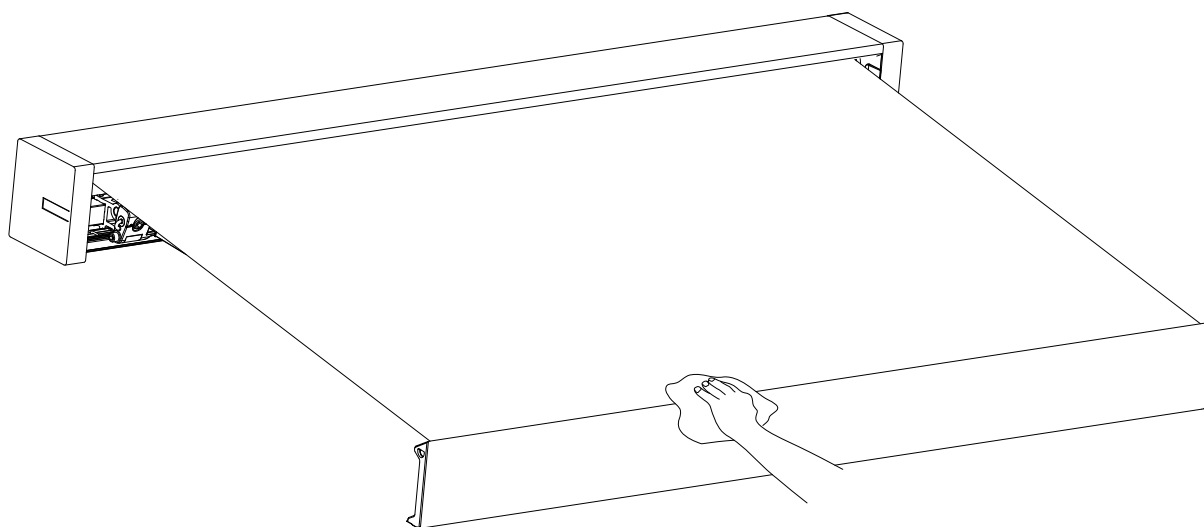
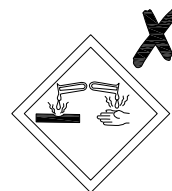
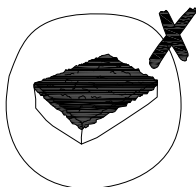
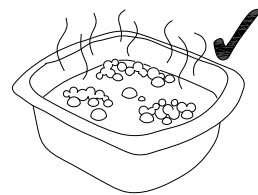
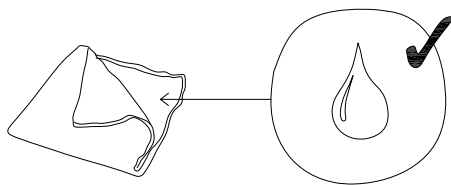
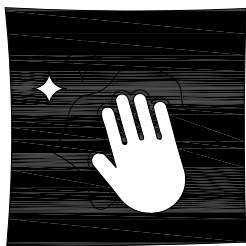

2.USE

Do not barbecue under the awning or ignite a fire near to the awning.

Don't use it in places that have vibrations or impulsions.

Don't use it in places of high temperature such as walls near furnaces.

Never use it in rainy and windy days.

Never use it for other purposes.

Please close the awning in windy and rainy days.

No modification of the awning in any kind is allowed.

Do not open the awning when maintenance, such as window cleaning, is being carried out in the vicinity.

Check the awning every 3 months to ensure all fixings are tightened and no damage on the products.

Do not use the awning if repair is needed. Do not try to repair the product by yourself, contact qualified person for repairing.

Save enough free space around the awning while rolling or unrolling.

3.MAINTENANCE

Always close the awning in windy days, heavy rain and when you are not using it.

The products need regularly maintenance, the gear box is the most vulnerable part of the product, so it needs to be checked and added the lubrication oil once for every three months.

Please do not unpick and wash the fabric. If you need replace the fabric, please turn to experts for help.

Check the overall installation and all the fasteners regularly, especially at the beginning of a new season, to ensure the fasteners are tightened and in good conditions.